

15" Charcoal Pizza Oven

Model:BMCHARPO

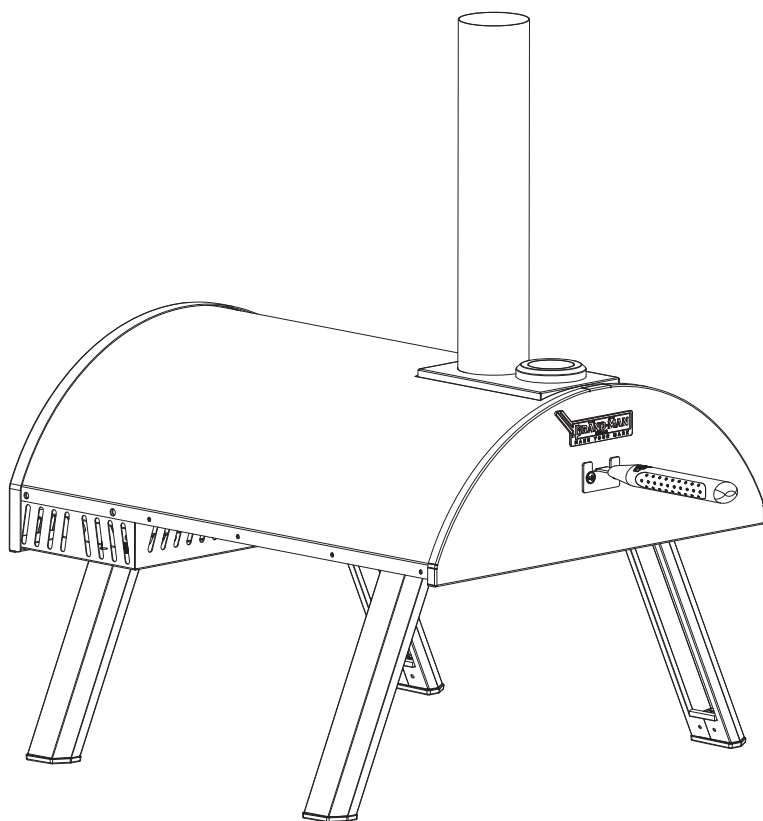

Important: Keep this Owner's Manual for convenient reference and for part replacement.

Read this Owner's manual carefully and be sure your gas grill is properly assembled, installed and maintained. Failure to follow these instructions could result in serious injury and/or property damage.

Please make sure the cylinder valve connection device shall properly and safely connected with the connection device attached to the inlet of the pressure regulator.

For Outdoor Use Only

Captivate Brands USA, Inc.
25541 Arctic Ocean Drive,
Lake Forest, CA.92630

If you have any questions or problems, you can contact our customer service at 1-855-200-8445 ext 102 or help@supportandspare.com from 9:00 AM - 5:00 PM Monday to Friday. (Pacific). All emails and voice-mail calls will be answered within 24 hours.

IMPORTANT HEALTH & SAFETY INFORMATION

FOR OUTDOOR USE ONLY! DO NOT USE INDOORS!

- Please read these instructions carefully prior to assembly and use.
- Failure to follow these instructions could lead to serious injury and/or significant damage to property.
- Do not start the oven if there is any doubt over the correct assembly, ignition or cooking of the unit.
- These instructions should be retained for future reference.
- The oven must be placed on a sturdy, level, stable and non-flammable surface and away from strong winds. Protect the floor with a suitable material if it is made of flammable material.
- Flammable materials and liquids must be kept away from the oven.
- Aerosols must not be used near the oven.
- The oven should not be moved when lit or hot.
- Never leave the oven unattended.
- Flames might blow outside from the front of the oven when you open the door and from the top of chimney.
- Please keep away from the openings of the oven and warn others around you.
- The oven becomes hot on the outside during use, handle with care to avoid burns.
- Operate the oven door by gripping the handle.
- Heat-resistant gloves should be worn when pulling out the charcoal bucket to refuel.
- Do not use any fuel other than charcoal.
- Do not turn the oven off by throwing water inside.
- Always allow the oven to completely cool down before covering.
- For safety reasons it is advisable to keep a fire extinguisher and fire blanket close to hand.
- Unsupervised children, elderly and infirm should not be allowed close to the oven during pre-heat, cooking, burn off or cooling down of the unit.
- Do not use the appliance as an incinerator or for any purpose other than that for which it was conceived.
- Please dispose of all polythene packing and plastic bags carefully and keep out of the reach of children.
- It is the users' responsibility to follow safe operation of the oven and to exercise reasonable standards of care at all times.

Table of Contents

| | |
|--|------|
| Important Health & Safety Information----- | 2 |
| Table of Contents----- | 3 |
| Parts Diagram----- | 4 |
| Parts List----- | 4 |
| Tools Required for Assembly----- | 4 |
| Assembly Steps ----- | 5-9 |
| Operating Instructions ----- | 9-10 |
| Cleaning and Care ----- | 11 |
| Warranty ----- | 12 |
| Customer Service----- | 12 |

Parts Diagram

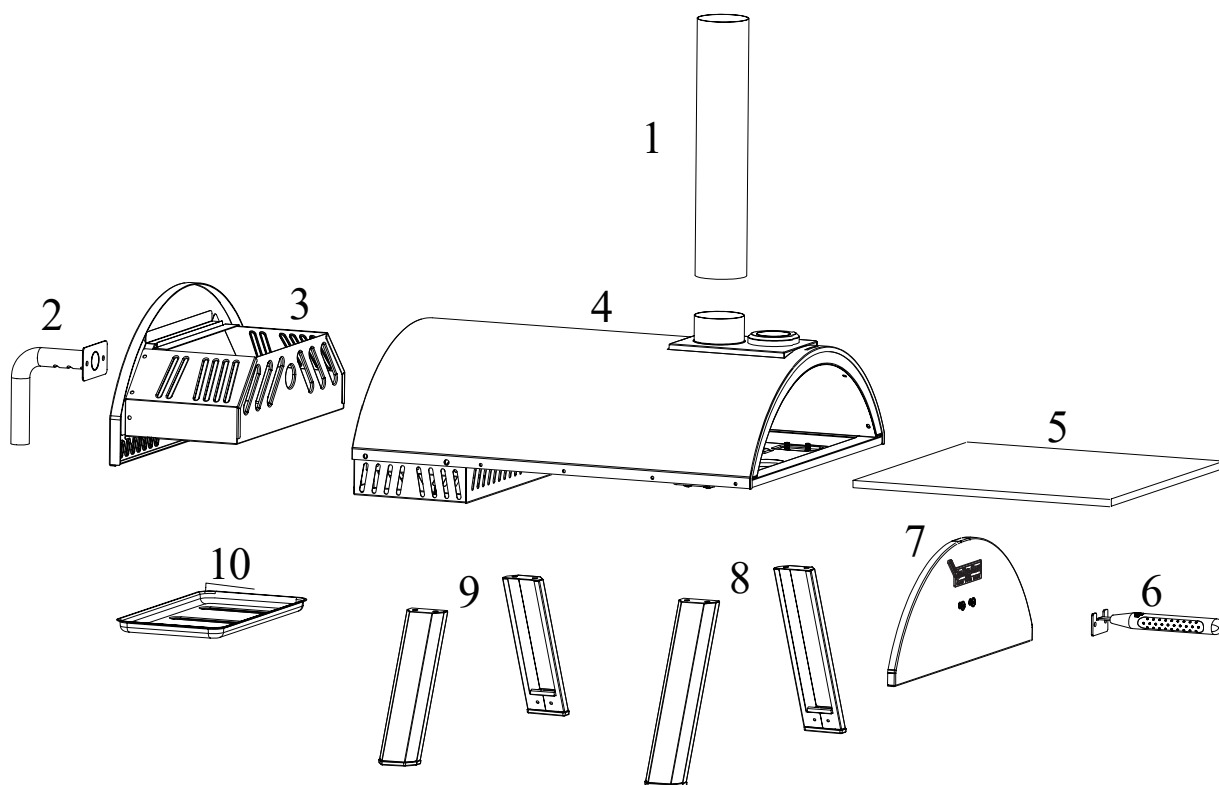

Parts List

| Part# | Description | QTY |
|-------|------------------------|-----|
| 1 | Chimney | 1PC |
| 2 | Charcoal Bucket Handle | 1PC |
| 3 | Charcoal Bucket | 1PC |
| 4 | Oven Body | 1PC |

| Part# | Description | QTY |
|-------|-------------|-----|
| 5 | Pizza Stone | 1PC |
| 6 | Door Handle | 1PC |
| 7 | Door | 1PC |
| | | |

| Part# | Description | QTY |
|-------|-------------|------|
| 8 | Front Legs | 2PCS |
| 9 | Back Legs | 2PCS |
| 10 | Ash Tray | 1PC |
| | | |

Tools Required for Assembly

Philips Head Screwdriver (not included)

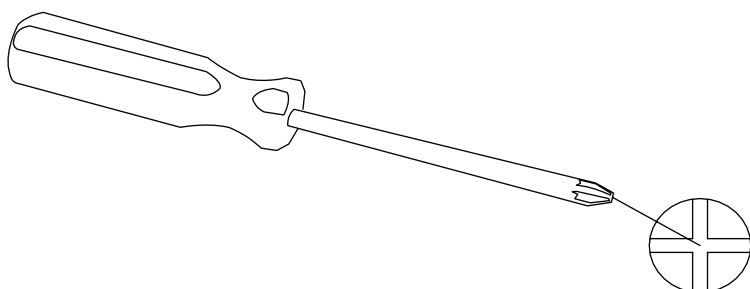

Step 1

- Remove all the pre-installed screws on the Oven Body (#4).
- Attach the Front Legs (#8) and Back Legs (#9) onto the Oven Body (#4) with the pre-installed screws as shown.
- Note: The Front Legs (#8) are longer than the Back Legs (#9).

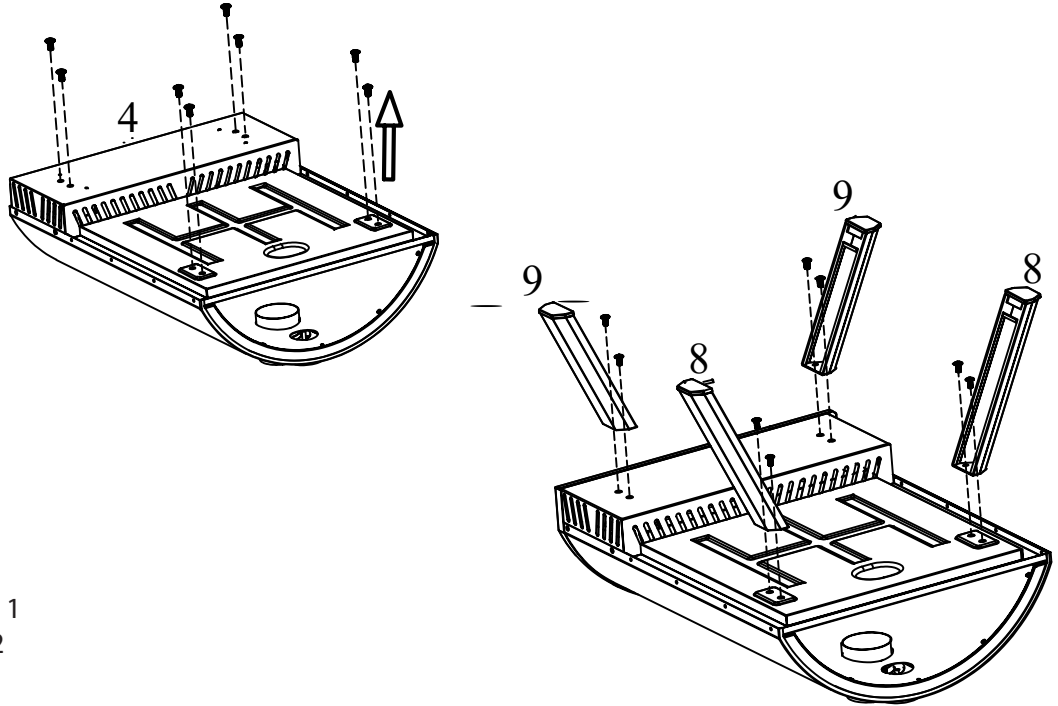

Parts Required:

- Oven Body (#4) x 1
- Front Leg (#8) x 2
- Back Leg (#9) x 2

Step 2

- Remove the pre-installed screws on the Charcoal Bucket (#3).
- Attach the Charcoal Bucket Handle (#2) onto the Charcoal Bucket (#3) with the pre-installed screws.

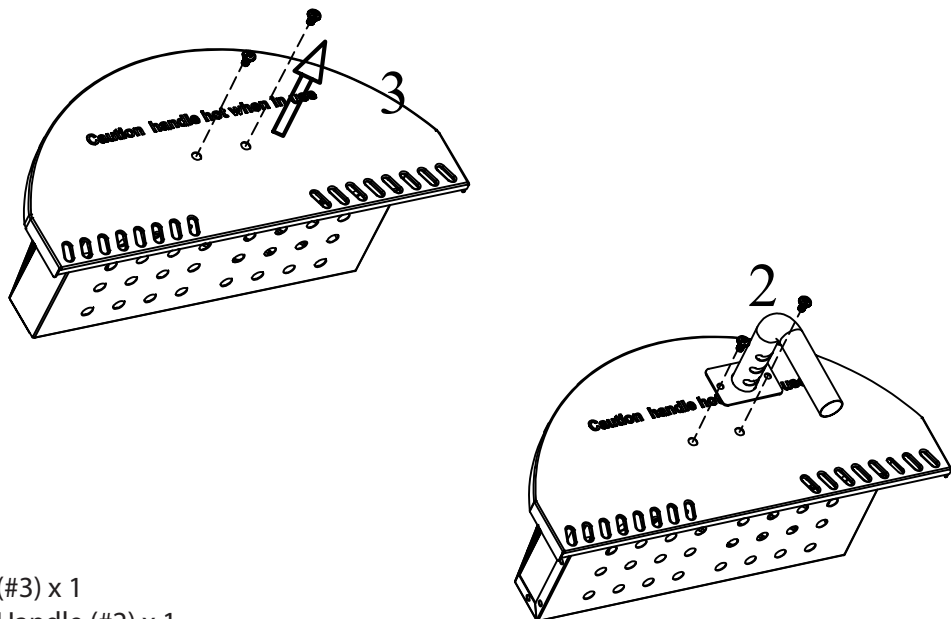

Parts Required:

- Charcoal Bucket (#3) x 1
- Charcoal Bucket Handle (#2) x 1

Step 3

- Put the oven in standing position.
- Insert the Ash Tray (#10) into the back of the Oven Body.

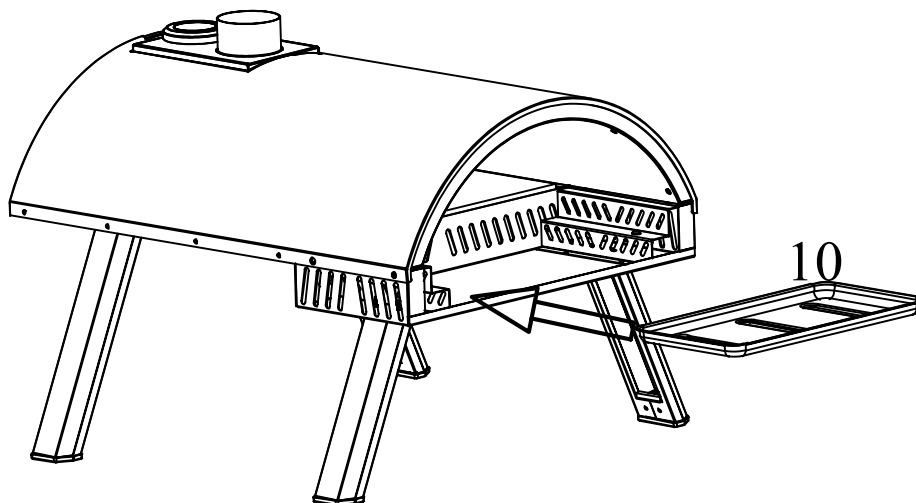

Parts Required:

- Ash Tray (#10) x 1

Step 4

- Insert the charcoal bucket prepared in step 2 into the back of the Oven Body as shown.

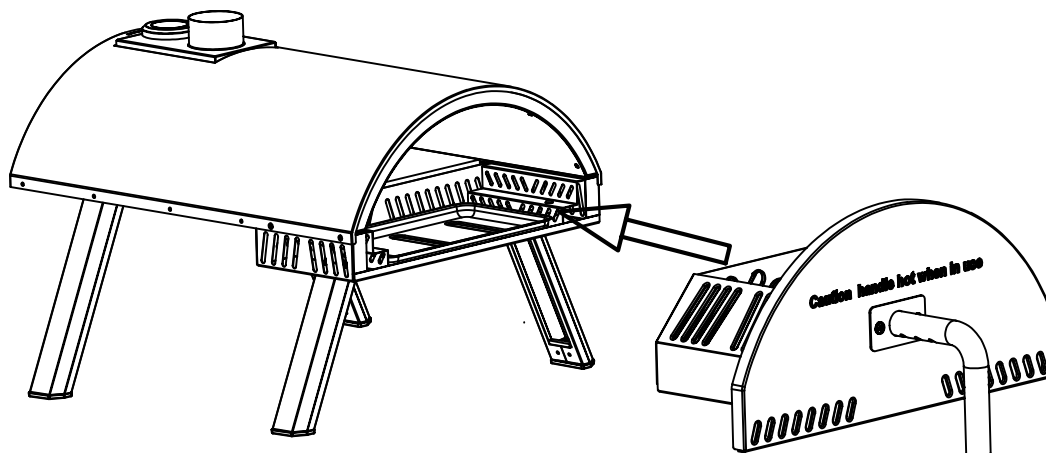

Assembly Steps

Step 5

- Remove the pre-installed screws on the Door (#7).
- Attach the Door Handle (#6) onto the Door (#7) with the two pre-installed screws.

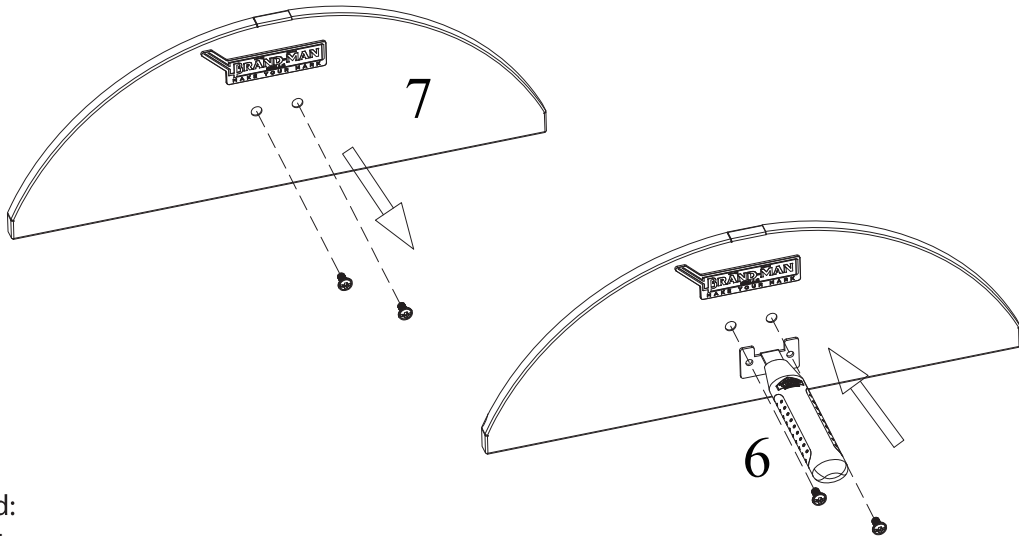

Parts Required:

- Door (#7) x 1
- Door Handle (#6) x 1

Step 6

- Place in the Pizza Stone (#5) into the oven from the front.

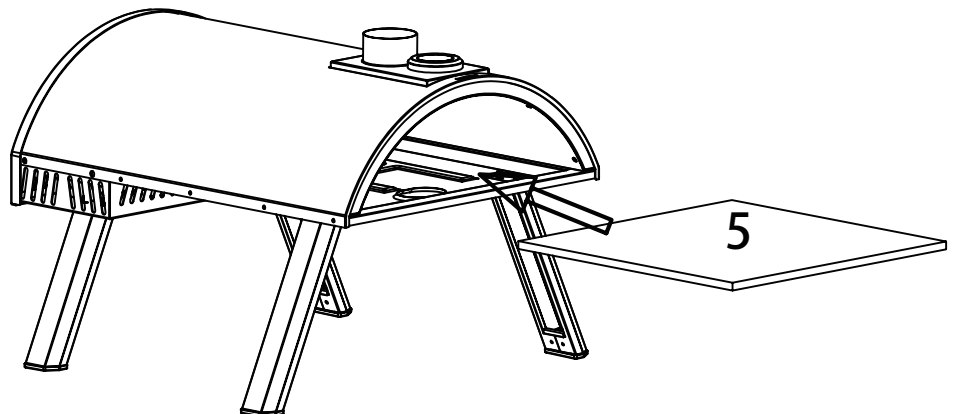

Parts Required:

- Pizza Stone (#5) x 1

Step 7

- Hook the door prepared in step 5 onto the oven as shown.

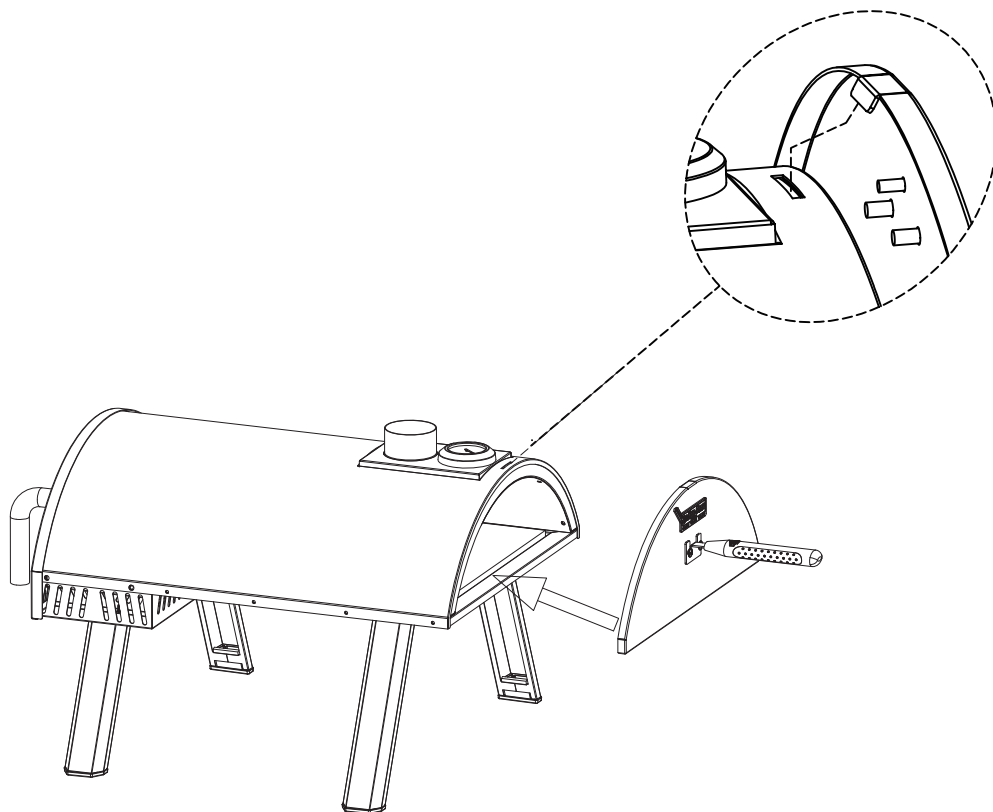

Step 8

- Attach Chimney (#1) onto the top of the oven as shown.

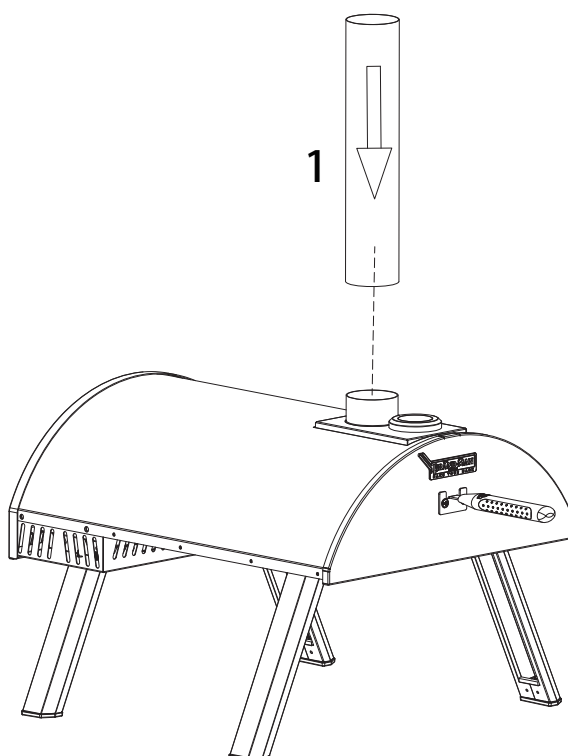

Parts Required:

- Chimney (#1) x 1

Assembly Steps

Step 9

Assembly is complete.

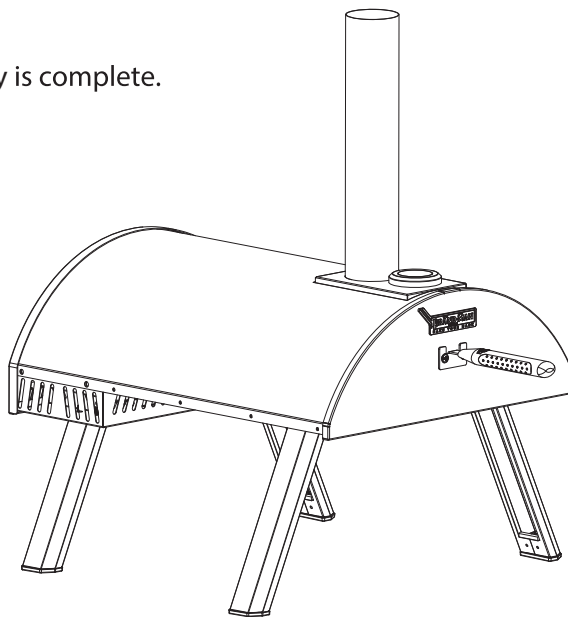

Operating Instructions

CAUTION: Never use charcoal that has been pre-treated with lighter fluid.

First Use

1. Make sure all labels, packaging and protective films have been removed from the Oven.
2. Remove manufacturing oils before cooking on the oven for the first time, by operation the Oven for at least 15 minutes. This will “heat clean” the internal parts and dissipate odors.

Lighting Instructions

CAUTION: Set the oven up on a hard non-combustible level surface.

CAUTION: Keep the outdoor cooking appliance area clear and free from combustible materials, gasoline and other flammable vapors and liquids.

CAUTION: Check to make sure the air vents are free of debris and ash before using the oven.

CAUTION: DO NOT use lighting fluid, gas or other combustible liquids to ignite the charcoal. Liquid chemicals are fire and explosion hazard and they will cause an undesirable taste to food.

CAUTION: DO NOT use “Instant Light” briquettes. This will cause the same undesirable taste.

1. Pull out the charcoal bucket and fill with 2-2.5kgs of charcoal.
2. Ignite charcoal as instructed on charcoal packaging.
3. Push the charcoal bucket back in to the oven.
4. Keep the door closed and wait until the desired temperature is reached.
5. Pre-heat for 15 to 20 minutes prior to cooking. Do not cook before the fuel has a coating of ash.

Note: A charcoal starter chimney is a helpful alternative for lighting.

Turning off

Let the oven burn through remaining charcoal and allow it to cool down naturally.

Do not turn the oven off by throwing water inside.

Do not remove ashes and clean the oven until it is completely cool.

Operating Instructions (Continue)

Tips for Cooking Pizza

1. Set up the oven on a hard non-combustible level surface.
2. Load and Light charcoal per "Lighting Instructions" section.
3. Make sure the door is closed and allow the oven to preheat for 15 to 20 minutes to get the stone hot enough. Add 5 to 10 more minutes if necessary to achieve the right stone temperature.
4. Form the pizza dough and place it on a peel dusted with a little flour or cornmeal.

Tip: Jiggle the peel to make sure the pizza isn't sticking. You want it to slide off the peel easily. If it's stuck, gently lift the sticky dough and dust with a wee bit more flour or cornmeal.

Tip: For toppings, less is more. Too much sauce or toppings can easily sog out the crust.

5. Slip the pizza onto the hot pizza stone and rotate the pizza every 30 to 45 seconds to bake it evenly.

Tip: Please keep the door closed throughout the cook unless adding, rotating or removing pizza.

6. The pizza is done when the cheese is melted to a medium-to-dark brown. Carefully remove the pizza with the peel and let it cool slightly. If you want, top it with additional fresh toppings.

Tip: It would take a few minutes to get the stone hot again after every pizza.

After Use Instructions

1. Make sure all coals are fully extinguished and the oven is completely cool.
2. Remove ashes.
3. Clean the pizza stone after each use as follows.

Please note the pizza stone will absorb whatever substance you use to clean it with, so please do not use soap, cleaning chemicals on the stone and expose the pizza stone to as little water as possible.

 - Let the stone cool completely.
 - Wet the surface with a small stream of hot water. Use as little water as you can because you will need to completely dry the pizza stone before using it again or storing it. You may not need to use water at all if you can scrape away food with the brush first. Water might help loosen food, but it's not necessary.
 - Use a stone brush to scrub the pizza stone thoroughly.
 - Wipe away any food particles with a damp rag.
 - Allow the pizza stone to air dry or use a clean towel to dry the stone.
4. Wipe off the oven surface, inner and outer walls with paper towels until clean.
5. Store in dry area.

DANGER!

DO NOT use charcoal briquettes for indoor cooking or heating. TOXIC carbon monoxide fumes can accumulate and cause asphyxiation and death!

DANGER!

This Oven is not intended to be installed in or on recreational vehicles and / or boats.

Care & Maintenance

CAUTION: BEFORE ANY CARE AND MAINTENANCE IS ATTEMPTED PLEASE ENSURE THAT THE OVEN ARE NOT IN USE AND THAT ALL SURFACES HAVE BEEN GIVEN SUFFICIENT TIME TO COOL DOWN.

Please note the following when maintaining and caring for your oven:

- Cleaning your oven regularly will help to keep a pristine appearance.
- Throwing cold water over any hot surface of the oven is NOT recommended and is potentially dangerous.
- Avoid handling and touching hot parts of the oven.

CARE OF THE OVEN BODY

- Regular care and maintenance of the oven body will significantly increase its life and long term appearance.
- Excess grease and fat can be removed using grease remover and warm water with a soft scraper (not metal edged).
- The oven body should be fully cleaned by using hot soapy water and a sponge to avoid corrosion starting on dirty surfaces.
- Leave a light film of oil such as cooking spray on the metal parts to assist in rust prevention.
- Regularly spray screws and fasteners with an appropriate lubricant or rust preventer.
- If external paint is scratched or chipped it must be immediately covered with paint or a rust preventer.
- Keep the oven covered when it not in use.

Warranty

Two-Year Limited Warranty

This warranty is non-transferable and does not cover failures due to misuse of improper installation or maintenance.

This warranty is for replacement of defective parts only. We are not responsible for incidental or consequential damages or labor costs.

This warranty does not cover corrosion or discoloration after the oven is used, or lack of maintenance, hostile environment, accidents, alterations, abuse or neglect.

This warranty does not cover damage caused by heat, abrasive and chemical cleaners, or any damage to other components used in the installation or operation of the oven. And paint is not warranted and may require touch-up.

This warranty is void if this oven is ever used for commercial or rental purposes.

All warranty coverage applies only if this oven is used in the United States.

Some states do not allow the limitation or exclusion of incidental or consequential damages, so the above limitations or exclusions may not apply to you. This warranty gives you specific legal rights, and you may also have other rights that vary from state to state.

Customer Service

Please do not return the oven to store.

If you have any questions or if you need replacement parts, please contact our customer service:

1-855-200-8445 ext 102 or
help@supportandspares.com

We are pleased to help you with any question concerning replacement parts or your warranty.

Proof of purchase in the form of an original receipt with date of purchase is required

DO NOT ship parts or units without a return authorization number. Upon receipt of an authorization number, the product must be shipped prepaid.

Captivate Brands USA, Inc.
25541 Arctic Ocean Drive,
Lake Forest, CA.92630

If you have any questions or problems,
you can contact our customer service at
1-855-200-8445 ext 102 or
help@supportandspare.com
from 9:00 AM - 5:00 PM Monday to Friday.
(Pacific). All emails and voice-mail calls
will be answered within 24 hours.